

ACCESSORI
ACCESSORIES
ZUBEHÖRE

ACCUMULATORI IDROPNEUMATICI
HYDROPNEUMATIC ACCUMULATORS - HYDROPNEUMATISCHE SPEICHER

| Type HR | P Max. 210 bar | T -20° +80° | Corpo - Body - Gehäuse Acciaio - Steel - Stahl | | | | Membrana - Diaphragm - Membrane | | |
|-------------------------------|---------------------|----------------------|---|---------|---------|---------|---------------------------------|-----|--------|
| CODICE Code Bestell-Nr. | TIPO Type Typ | "N" Volume Lt. | Q max l/mm | H mm | D mm | E mm | F | Kg. | EURO |
| ACH0000100 | H 100 R | 0,15 | 40 | 142 | 70 | 45 | M18x1,5 | 1,2 | 87,24 |
| ACH0000350 | H 350 R | 0,35 | 35 | 200 | 70 | 45 | M18x1,5 | 1,7 | 95,81 |
| ACH0000500 | H 500 R | 0,45 | 50 | 167 | 92 | 55 | M18x1,5 | 1,9 | 99,60 |
| ACH0000700 | H 700 R | 0,70 | 40 | 220 | 92 | 55 | M18x1,5 | 2,7 | 110,94 |
| ACH0001000 | H1000 R | 1,00 | 50 | 195 | 115 | 60 | M18x1,5 | 3,5 | 133,64 |
| ACH0001400 | H1400 R | 1,40 | 40 | 260 | 115 | 60 | M18x1,5 | 4,9 | 174,74 |

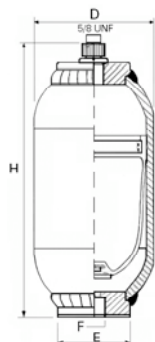

| Type HTR | P Max. 210 bar | T -20° +80° | Corpo - Body - Gehäuse Acciaio - Steel - Stahl | | | | Sacca Sostituibile | Replaceable Bladder | Ersetzbare Blase |
|-------------------------------|---------------------|----------------------|---|---------|---------|---------|-----------------------|------------------------|---------------------|
| CODICE Code Bestell-Nr. | TIPO Type Typ | "N" Volume Lt. | Q max l/mm | H mm | D mm | B mm | F | Kg. | EURO |
| ACHTR00350 | HTR 0,35 | 0,35 | 45 | 155 | 92 | 20 | M18x1,5 | 2,5 | 113,46 |
| ACHTR00700 | HTR 0,7 | 0,75 | 40 | 220 | 92 | 20 | M18x1,5 | 3,7 | 128,59 |
| ACHTR01500 | HTR 1,5 | 1,50 | 40 | 280 | 115 | 25 | M18x1,5 | 5,9 | 199,19 |
| ACHTR02500 | HTR 2,5 | 2,50 | 110 | 483 | 115 | 50 | 3/4" BSP | 12 | 451,34 |
| ACHTR04501 | HTR 4,5 | 4,50 | 400 | 395 | 170 | 80 | 1.1/4" BSP | 16 | 592,54 |
| ACHTR10000 | HTR 10 | 10,00 | 300 | 760 | 170 | 80 | 1.1/4" BSP | 31 | 887,55 |

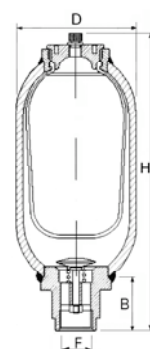

SU RICHIESTA - ON REQUEST - AUF ANFRAGE
UNITA' DI PRECARICA E CONTROLLO - FILLING AND TESTING UNIT - FÜLL-UND PRÜFVORRICHTUNG

PRESSOSTATI
PRESSURE SWITCHES - DRUCKSCHALTER

| CODICE Code Bestell-Nr. | TIPO Type Typ | FILETTO Thread Gewinde | Campo di taratura Setting Range Eichungsbereich | Kg. | EURO |
|-------------------------------|---------------------|------------------------------|---|------|--------|
| APIF530000 | F 53 | 1/4" | 5 > 50 bar | 0,15 | 100,86 |
| APIF550000 | F 55 | " | 15 > 150 bar | " | 100,86 |
| APIF570000 | F 57 | " | 30 > 300 bar | " | 100,86 |



CORPO - BODY - GEHÄUSE: ALUMINIO - ALUMINIUM - ALUMINIUM

| CODICE Code Bestell-Nr. | TIPO Type Typ | FILETTO Thread Gewinde | Campo di taratura Setting Range Eichungsbereich | Kg. | EURO |
|-------------------------------|---------------------|------------------------------|---|------|-------|
| APIF4R10P2 | F4R-1P2 | 1/4" | 0,2 > 2,5 bar | 0,05 | 23,70 |
| APIF4S10P2 | F4S-1P2 | " | 1 > 12 bar | " | 23,70 |
| APIF4T10P2 | F4T-1P2 | " | 5 > 50 bar | " | 26,48 |
| APIF4V10P2 | F4V-1P2 | " | 10 > 100 bar | " | 26,48 |
| APIF4Z10P2 | F4Z-1P2 | " | 20 > 200 bar | " | 26,48 |



MANOMETRO CON GLICERINA (ATTACCO RADIALE)
GLYCERINE PRESSURE GAUGE (RADIAL FITTING) - GLYZERINMANOMETER (RADIALANSCHLUSS)

| CODICE Code Bestell-Nr. | Ø mm | FILETTO Thread Gewinde | SCALA bar Range bar Bereiche bar | Kg. | EURO |
|-------------------------------|---------|------------------------------|--|------|-------|
| AMGR063010 | 63 | 1/4" | 0 / 10 | 0,20 | 19,54 |
| AMGR063025 | " | " | 0 / 25 | " | 19,54 |
| AMGR063060 | " | " | 0 / 60 | " | 19,54 |
| AMGR063100 | " | " | 0 / 100 | " | 19,54 |
| AMGR063160 | " | " | 0 / 160 | " | 19,54 |
| AMGR063250 | " | " | 0 / 250 | " | 19,54 |
| AMGR063400 | " | " | 0 / 400 | " | 19,54 |
| AMGR063600 | " | " | 0 / 600 | " | 26,77 |



CASSA IN ACCIAIO INOSSIDABILE - STAINLESS STEEL CASING - EDELSTAHLGEHÄUSE